

| REV. | DESCRIPTION           | ECN NO. | NAME | DATE       |
|------|-----------------------|---------|------|------------|
| 0    | FIRST EDITION         | N/A     | SYH  | 2020-03-01 |
| 1    | REMOVE THE BMA GASKET | N/A     | SYH  | 2020-04-07 |
| 2    | UPDATE GASKET         | N/A     | YJY  | 2021-06-30 |

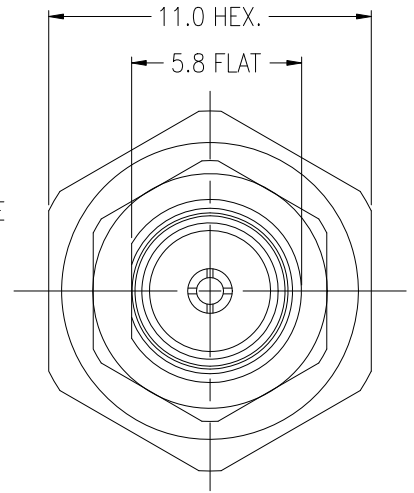

ALL PARTS MUST MEET TO RoHS REQUIREMENTS

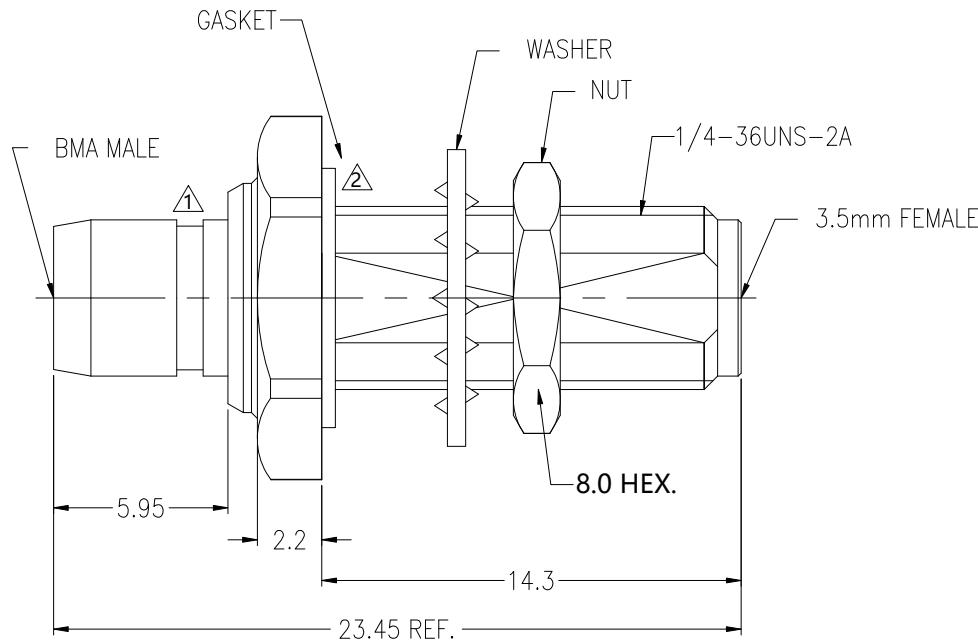

| MATERIALS AND PLATING UNIT: MICRO-INCHES |                       |                            |
|--|-----------------------|----------------------------|
| PART NAME                                | MATERIALS             | PLATING                    |
| BODY                                     | STAINLESS STEEL 303Cu | PASSIVATION                |
| INSULATOR                                | PEI OR PEEK           | N/A                        |
| CONTACT PIN                              | BERYLLIUM COPPER      | PL.GOLD15u" /NICKEL/COPPER |
| NUT                                      | STAINLESS STEEL 303Cu | PASSIVATION                |
| WASHER                                   | STAINLESS STEEL 304Cu | PASSIVATION                |

| ELECTRICAL CHARACTERISTICS      |                     |         |
|---------------------------------|---------------------|---------|
| IMPEDANCE                       | 50 Ω                |         |
| VOLTAGE RATING                  | 175 V(rms)          |         |
| FREQUENCY RANGE                 | DC ~ 26.5 GHz       |         |
| DIELECTRIC WITHSTANDING VOLTAGE | > 500 V             |         |
| CONTACT RESISTANCE              | CENTER CONTACT      | <3.0 mΩ |
|                                 | OUTER CONTACT       | <2.0 mΩ |
| INSULATION RESISTANCE           | > 5000 MΩ           |         |
| INSERTION LOSS                  | <0.08x√F(GHz) dB    |         |
| VSWR                            | <1.25 @DC ~ 18GHz   |         |
|                                 | <1.35 @18 ~ 26.5GHz |         |
| 3RD INTERMODULATION             | N/A                 |         |

| MECHANICAL CHARACTERISTICS     |             |
|--------------------------------|-------------|
| FORCE TO ENGAGE AND DISENGAGE  | N/A         |
| CENTER CONTACT RETENTION FORCE | >6 lbs      |
| RECOMMENDED COUPLING TORQUE    | N/A         |
| COUPLING NUT RETENTION FORCE   | N/A         |
| DURABILITY                     | >500 cycles |

| ENVIRONMENTAL PARAMETER |                |
|-------------------------|----------------|
| TEMPERATURE RANGE       | -55 °C~+120 °C |

**\* CUSTOMER OUTLINE DRAWING**

UNLESS OTHERWISE SPECIFIED:  
 1) EDGES : C0.15 MAX ;  
 2) REMOVE ALL BURRS ;  
 3) SURFACE ROUGHNESS : Ra1.6 ;  
 4) UNITS : mm ;  
 5) DIMENSIONS TOLERANCES  
 DECIMALS : .x ±0.3 .xx ±0.2 .xxx±0.1;  
 ANGLES : ± 5°.

THIRD ANGLE PROJECTION

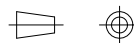

APPROVED :

CUSTOMER P/N :

CHECKED :

SCALE :

1 : 1

DRAWING :

DATE : 2020-06-30

PAGE : 1/1

TITLE : 3.5mm FEMALE TO BMA MALE BULKHEAD ADAPTOR,50Ω

DRAWING NO. :

T-5BMM36S-P3F

COMPANY WEBSITE : www.slkcorp.com

CUSTOMER OUTLINE DRAWING