

REV.	DESCRIPTION	ECN NO.	NAME	DATE			
0	FIRST EDITION	N/A	Liu	2021-04-20			

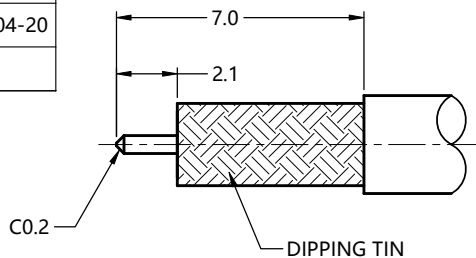

ALL PARTS MUST MEET TO RoHS REQUIREMENTS

REMARKS:
 1. CONTACT PIN TO CAPTIVE
 2. BARREL TO SOLDER
 3. ADD SIZE: 6.8 mm



RECOMMENDED CABLE STRIPPING DIM'S

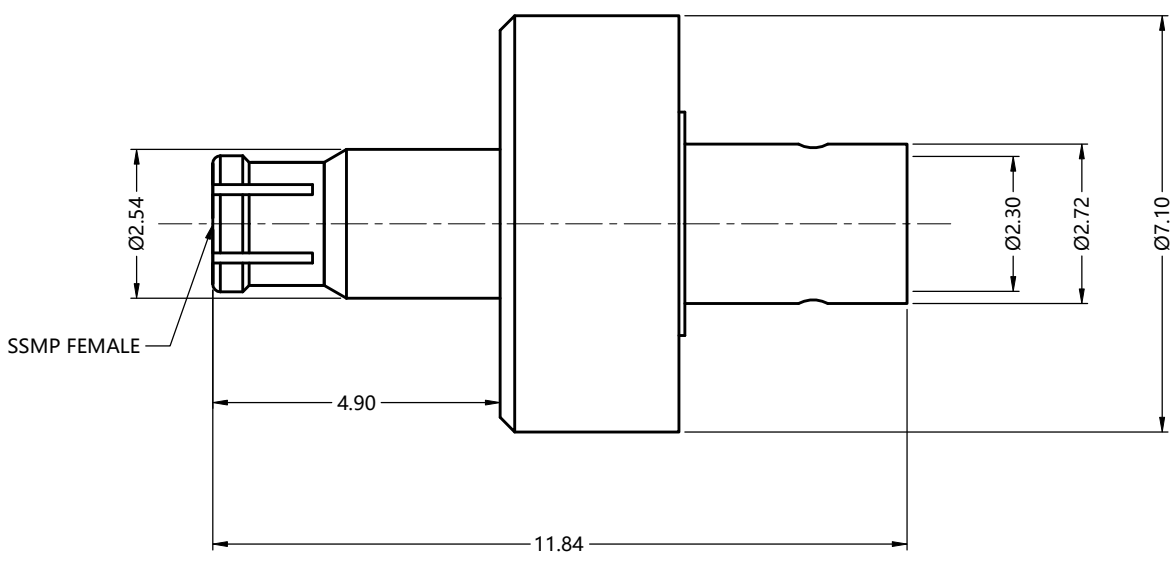

MATERIALS AND PLATING		UNIT: MICRO-INCHES
PART NAME	MATERIALS	PLATING
BODY	BRASS	GOLD 15 u"/NICKEL/COPPER
INSULATOR	PTFE ASTM-D-1710	N/A
CONTACT PIN	Be-Cu C17300	GOLD 50 u"/NICKEL/COPPER
OUT CONTACT	Be-Cu C17300	GOLD 15 u"/NICKEL/COPPER
BARREL	STAINLESS STEEL	GOLD 15 u"/NICKEL/COPPER

ELECTRICAL CHARACTERISTICS	
IMPEDANCE	50 Ω
VOLTAGE RATING	N/A
FREQUENCY RANGE	DC ~ 6 GHz
DIELECTRIC WITHSTANDING VOLTAGE	> 500 V
CONTACT RESISTANCE	CENTER CONTACT < 6.0 mΩ
	OUTER CONTACT < 2.0 mΩ
INSULATION RESISTANCE	> 1000 MΩ
INSERTION LOSS	< 0.10x√F(GHz) dB
VSWR	< 1.15
3RD INTERMODULATION	N/A

MECHANICAL CHARACTERISTICS		
CENTER CONTACT RETENTION FORCE		> 3 lbs
Engagement force	Full detent	< 4.5 lbs
	Smooth bore	< 2.5 lbs
Disengagement force	Full detent	< 6.5 lbs
	Smooth bore	< 1.5 lbs
DURABILITY	Full detent	> 100 cycles
	Smooth bore	> 500 cycles

ENVIRONMENTAL PARAMETER	
TEMPERATURE RANGE	-40 °C ~ +125 °C

CUSTOMER OUTLINE DRAWING

* CUSTOMER OUTLINE DRAWING

UNLESS OTHERWISE SPECIFIED:
 1) EDGES : C0.15 MAX ;
 2) REMOVE ALL BURRS ;
 3) SURFACE ROUGHNESS : Ra1.6 ;
 4) UNITS : mm ;
 5) DIMENSIONS TOLERANCES
 DECIMALS : .x ±0.3 .xx ±0.2 .xxx±0.1;
 ANGLES : ± 5°.

THIRD ANGLE PROJECTION		
APPROVED :	CUSTOMER P/N :	-
CHECKED :	SCALE :	-
DRAWING :	DATE :	2021-04-20
PAGE : 1/1		

SLK
 SUPERLINK

TITLE : SSMP FEMALE S/T SOLDER FOR Tflex-405 CABLE,50Ω

DRAWING NO. : 5MPF15S-A82-010

COMPANY WEBSITE : www.slkcorp.com